

LEGEND

- NEW BUILDING
- ASPHALT
- LANDSCAPE
- CONC. PAVEMENT, 150MM RAISED
- LANDSCAPE BUFFER
- ♿ HANDICAP PARKING
- ▶ MAIN ENTRANCE
- ◀ OVERHEAD DOOR
- ▬ BARRIER CURB



2 KEY PLAN
A-1.0 SCALE -NTS

PROJECT STATISTICS-

ADDRESS: 233, 249, 261 COLDWATER ROAD, ORILLIA, ON.

ZONING : R5i (H2)

	REQUIRED	PROVIDED
LOT(SITE) AREA (m ²)	1000 SQM.	15426.96 (3.81 ACRE)
ROAD WIDENING		350.78 SQM.
NET LOT AREA		15076.18 SQM. (3.72 ACRE)
LOT FRONTAGE MIN.	30.0 M.	118.35 M.
LOT DEPTH MIN.		93.80 M.
GROUND FLOOR AREA (m ²)		3390.85 SQM.
GROSS FLOOR AREA (m ²)	300.00 SQM.	22008.67 SQM.
BLDG. COVERAGE	60.0%	22.49%
BUILDING HT.	12.5 M. (MAX)	28.35 M.
PAVED AREA		1205.72 SQM
LANDSCAPE (MIN.)	40.0%	4142.87 SQM (35.7%)

BUILDING SETBACKS

	REQUIRED	PROVIDED
FRONT SETBACK (NORTH) (COLDWATER ROAD)	5.0 M.	5.05 M.
REAR SETBACK (SOUTH)	7.5 M.	7.50 M.
INT. SIDE SETBACK (WEST)	6.0 M.	6.0 M.
INT. SIDE SETBACK (EAST)	6.0 M.	40.40 M.

PARKING CALCULATION

	REQUIRED	PROVIDED
RESIDENTIAL UNITS - 225 UNITS 1.5 SPACES PER UNIT (2.7 M. X 6.0 M.)	338	265
ACCESSIBLE PARKING SPACE (TYPE A - 3.4 M X 6.0 M)	4	4
ACCESSIBLE PARKING SPACE (TYPE B - 2.4 M X 6.0 M)	5	5
TOTAL PARKING SPACES	338(INCL. 9 B/F)	265 (INCL. 9 B/F)
VISITOR PARKING (25% OF PARKING SPACES)	85	23
BICYCLE PARKING 1/10 PARKING SPACES	34	34

LOADING PROVISIONS

	REQUIRED	PROPOSED
LOADING SPACE (7.95 M X 3.4 M)	0	1

MUNICIPAL ADDRESS AND LEGAL DESCRIPTION
233, 249, 261 COLDWATER ROAD, ORILLIA, ONTARIO
PART OF LOT 7, CONCESSION 4
CITY OF ORILLIA
COUNTY OF SIMCOE

APPLICANT
n Architecture Inc
208- 9120 LESLIE STREET,
RICHMOND HILL, ON., L4B 3J9
T: 416. 256. 9741
E: info@narchitecture.com
www.narchitecture.com

SURVEY
YOUNG & YOUNG SURVEYING INC.
2 HOLLAND DRIVE, UNIT-5, BOLTON
ONTARIO L7E 1E1
T: 905.951.6000
E: info@youngsurveying.ca
W: www.youngsurveying.ca

OWNER:

n Architecture Inc
PRINCIPAL: NITIN MALHOTRA, ARCHITECT.
9120 Leslie Street, Suite-208
Richmond Hill, Ontario. L4B 3J9
T : 4 1 6 . 2 5 6 . 9 7 4 1
E: info@narchitecture.com

ONTARIO ASSOCIATION OF ARCHITECTS
NITIN MALHOTRA
LICENCE 6211

PROJECT NORTH

3rd OCTOBER 2022
ISSUED FOR SPA 1

No.	Date	Version	Dwn.
1.	2022-10-03	ISSUED FOR SPA 1	NG.

This drawing is copyright property of 'n Architecture Inc'. Not to be reproduced. Contractor must verify all job dimensions, drawings, details and specifications and report any discrepancies to the architect before proceeding with work.

PROJECT:
CONDOMINIUM
233,249,261
COLDWATER ROAD,
WEST, ORILLIA

DRAWING TITLE:
SITE PLAN
(GROUND LEVEL)

DRAWN BY: NG	DATE: 15 FEBRUARY 2021
CHECKED BY: NM	SCALE: AS NOTED
PROJECT NO.:	DRAWING NO.:
21-23	A-1.0

1 SITE PLAN (GROUND LEVEL)
A-1.0 SCALE -1:350

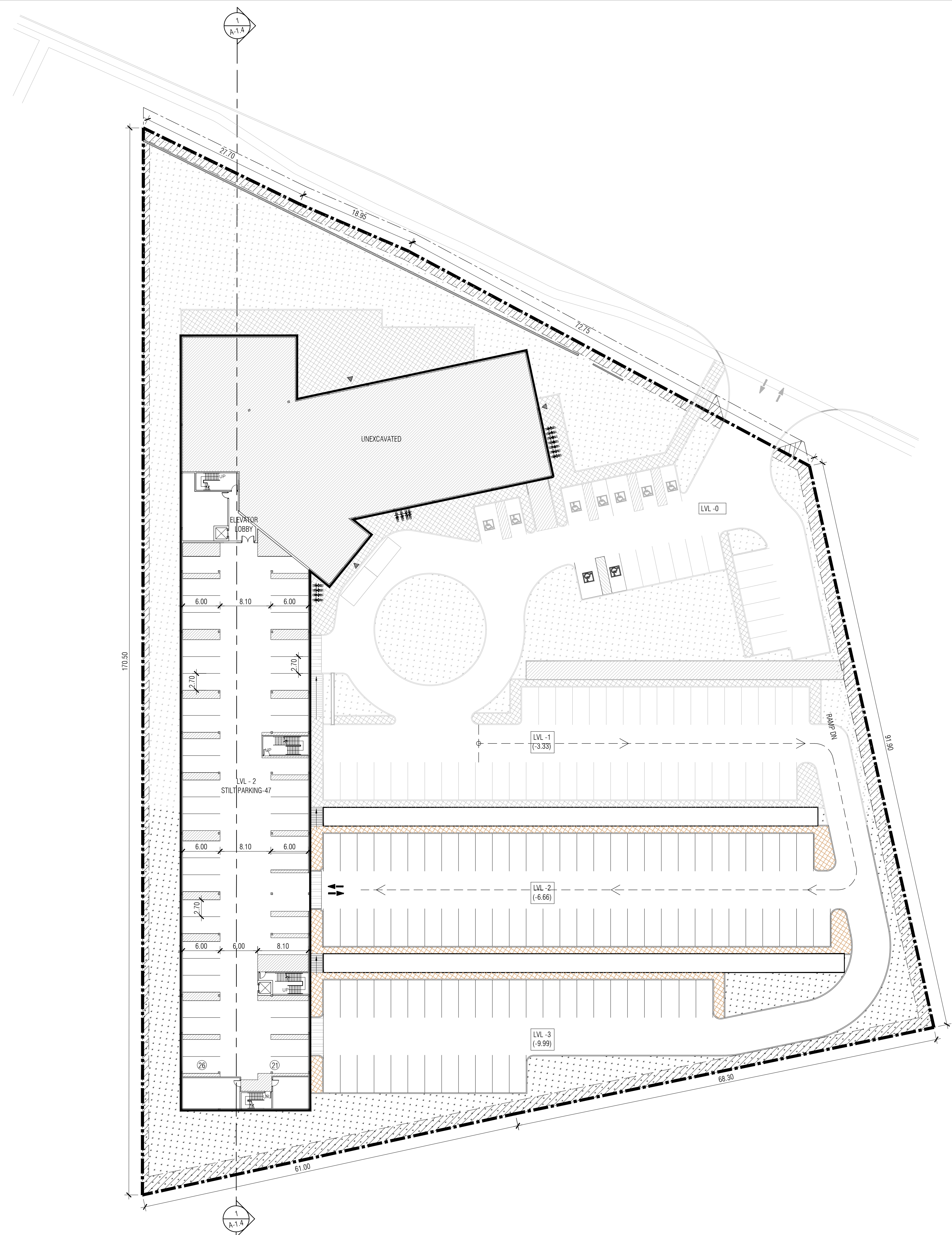

1 SITE PLAN (LEVEL -2)
A-1.0a SCALE -1:350

n Architecture Inc
 PRINCIPAL: NITIN MALHOTRA, ARCHITECT.
 9120 Leslie Street, Suite-208
 Richmond Hill, Ontario. L4B 3J9
 T : 4 1 6 . 2 5 6 . 9 7 4 1
 E : info@narchitecture.com
 .com

ONTARIO ASSOCIATION OF ARCHITECTS
 NITIN MALHOTRA
 LICENCE 6211

N
 PROJECT NORTH

3rd OCTOBER 2022
 ISSUED FOR SPA 1

1.	2022-10-03	ISSUED FOR SPA 1	NG.
----	------------	------------------	-----

No.	Date	Version	Dwn.
1.	2022-10-03	ISSUED FOR SPA 1	NG.

This drawing is copyright property of 'n Architecture Inc'. Not to be reproduced. Contractor must verify all job dimensions, drawings, details and specifications and report any discrepancies to the architect before proceeding with work.

PROJECT:
**CONDOMINIUM
 233,249,261
 COLDWATER ROAD,
 WEST, ORILIA**

DRAWING TITLE:
**SITE PLAN
 (LEVEL -2)**

DRAWN BY: NG DATE: 15 FEBRUARY 2021

CHECKED BY: NM SCALE: AS NOTED

PROJECT NO.: DRAWING NO.:

21-23 A-1.0a

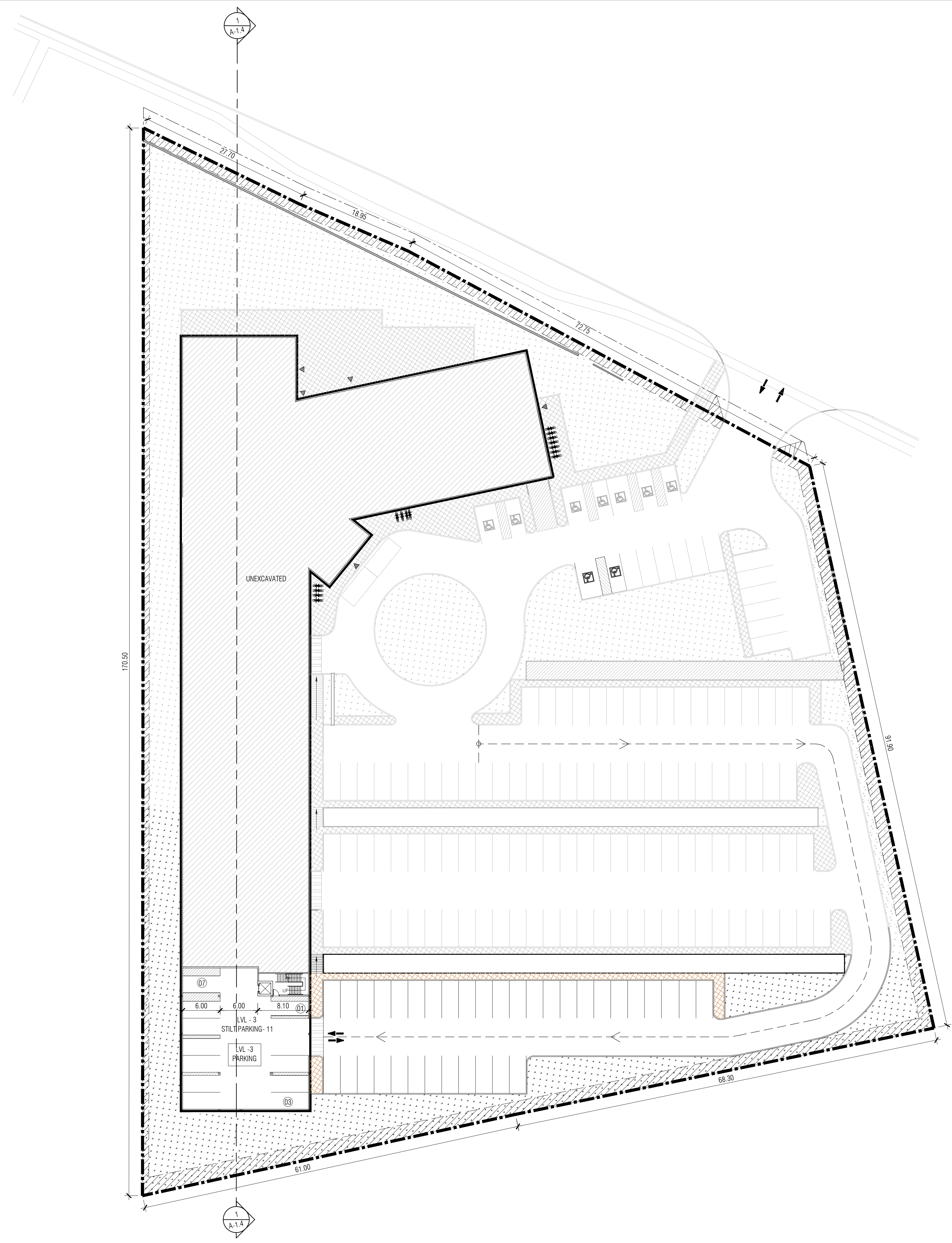

1 SITE PLAN (LEVEL -3)
A-1.0b SCALE -1:350

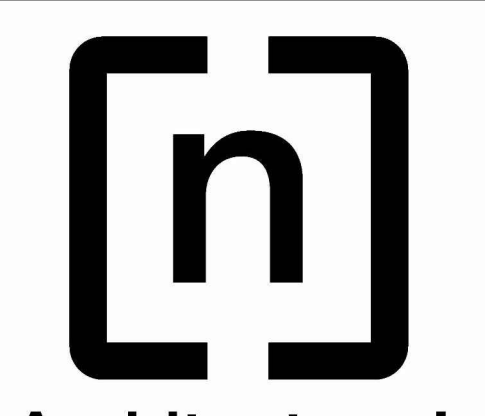

n Architecture Inc
 PRINCIPAL: NITIN MALHOTRA, ARCHITECT.
 9120 Leslie Street, Suite-208
 Richmond Hill, Ontario. L4B 3J9
 T : 4 1 6 . 2 5 6 . 9 7 4 1
 E: info@narchitecture.com

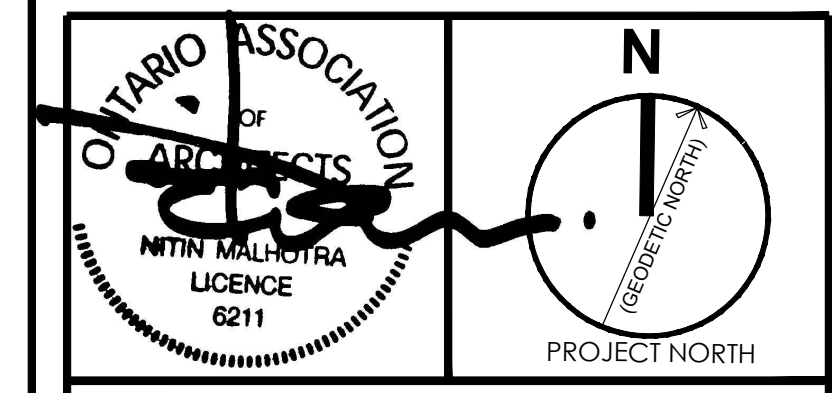

3rd OCTOBER 2022
 ISSUED FOR SPA 1

No.	Date	Version	Dwn.
1.	2022-10-03	ISSUED FOR SPA 1	NG.

This drawing is copyright property of 'n Architecture Inc'. Not to be reproduced. Contractor must verify all job dimensions, drawings, details and specifications and report any discrepancies to the architect before proceeding with work.

PROJECT:
**CONDOMINIUM
 233,249,261
 COLDWATER ROAD,
 WEST, ORILIA**

DRAWING TITLE:
**SITE PLAN
 (LEVEL -3)**

DRAWN BY: NG	DATE: 15 FEBRUARY 2021
CHECKED BY: NM	SCALE: AS NOTED
PROJECT NO.:	DRAWING NO.:
21-23	A-1.0b

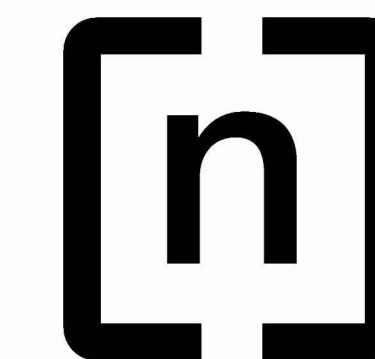

n Architecture Inc
 PRINCIPAL: NITIN MALHOTRA, ARCHITECT.
 9120 Leslie Street, Suite-208
 Richmond Hill, Ontario. L4B 3J9
 T : 4 1 6 . 2 5 6 . 9 7 4 1
 E: info@narchitecture.com
 www.narchitecture.com

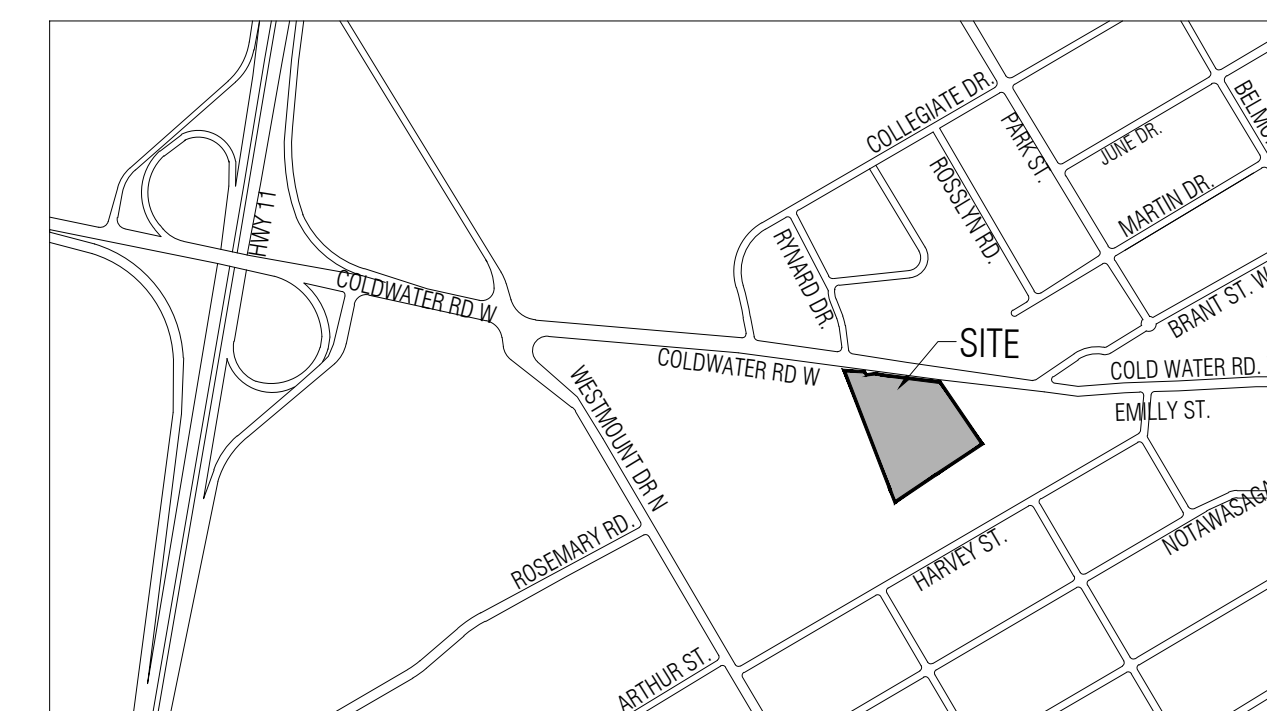
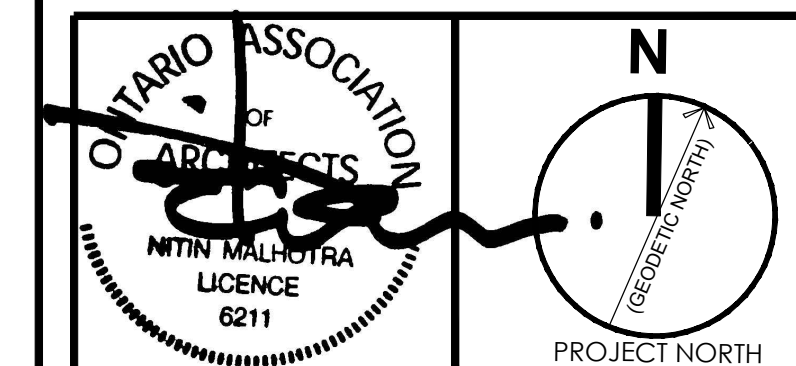

2 KEY PLAN
 A-1.0 SCALE -NTS

PROJECT STATISTICS-

ADDRESS: 233, 249, 261 COLDWATER ROAD, ORILLIA, ON.

ZONING : R5i (H2)

	REQUIRED	PROVIDED
LOT(SITE) AREA (m ²)	1000 SQM.	15426.96 (3.81 ACRE)
ROAD WIDENING		350.78 SQM.
NET LOT AREA		15076.18 SQM. (3.72 ACRE)
LOT FRONTAGE MIN.	30.0 M.	118.35 M.
LOT DEPTH MIN.		93.80 M.
GROUND FLOOR AREA (m ²)		3390.85 SQM.
GROSS FLOOR AREA (m ²)	300.00 SQM.	22008.67 SQM.
BLDG. COVERAGE	60.0%	22.49%
BUILDING HT.	12.5 M. (MAX)	28.35 M.
PAVED AREA		1205.72 SQM
LANDSCAPE (MIN.)	40.0%	4142.87 SQM (35.7%)

BUILDING SETBACKS

	REQUIRED	PROVIDED
FRONT SETBACK (NORTH) (COLDWATER ROAD)	5.0 M.	5.05 M.
REAR SETBACK (SOUTH)	7.5 M.	7.50 M.
INT. SIDE SETBACK (WEST)	6.0 M.	6.0 M.
INT. SIDE SETBACK (EAST)	6.0 M.	40.40 M.

PARKING CALCULATION

	REQUIRED	PROVIDED
RESIDENTIAL UNITS - 225 UNITS (2.7 M. X 6.0 M.)	338	265
ACCESSIBLE PARKING SPACE (TYPE A - 3.4 M X 6.0 M)	4	4
ACCESSIBLE PARKING SPACE (TYPE B - 2.4 M X 6.0 M)	5	5
TOTAL PARKING SPACES	338 (INCL. 9 B/F)	265 (INCL. 9 B/F)
VISITOR PARKING (25% OF PARKING SPACES)	85	23
BICYCLE PARKING 1/10 PARKING SPACES	34	34

LEGEND

- NEW BUILDING
- ASPHALT
- LANDSCAPE
- CONC. PAVEMENT, 150MM RAISED
- LANDSCAPE BUFFER
- HANDICAP PARKING
- MAIN ENTRANCE
- OVERHEAD DOOR
- BARRIER CURB

MUNICIPAL ADDRESS AND LEGAL DESCRIPTION
 233, 249, 261 COLDWATER ROAD,
 ORILLIA, ONTARIO
 PART OF LOT 7, CONCESSION 4
 CITY OF ORILLIA
 COUNTY OF SIMCOE

SURVEY
 YOUNG & YOUNG SURVEYING INC.
 2 HOLLAND DRIVE, UNIT-5, BOLTON
 ONTARIO L7E 1E1
 T: 905.951.6000
 E: info@youngsurveying.ca
 W: www.youngsurveying.ca

APPLICANT
 n Architecture Inc
 208- 9120 LESLIE STREET,
 RICHMOND HILL, ON., L4B 3J9
 T: 416. 256. 9741
 E: Info@narchitecture.com
 www.narchitecture.com

OWNER:

1 SITE PLAN (ROOF LEVEL)
 A-1.1 SCALE -1:350

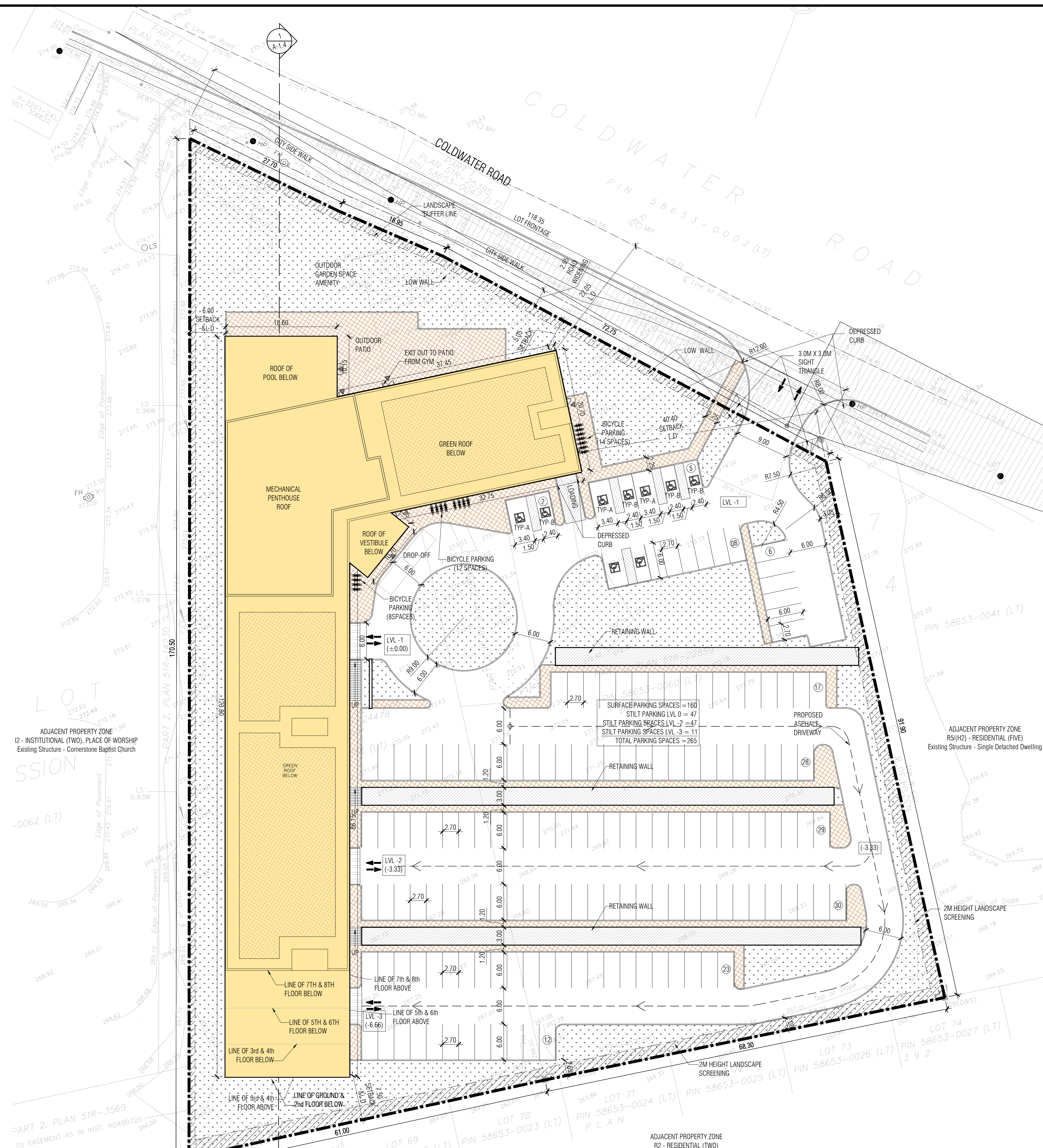

3rd OCTOBER 2022
 ISSUED FOR SPA 1

No.	Date	Version	Dwn.
1.	2022-10-03	ISSUED FOR SPA 1	NG.

This drawing is copyright property of 'n Architecture Inc'. Not to be reproduced. Contractor must verify all job dimensions, drawings, details and specifications and report any discrepancies to the architect before proceeding with work.

PROJECT:
CONDOMINIUM
233,249,261
COLDWATER ROAD,
WEST, ORILLIA

DRAWING TITLE:
SITE PLAN
(ROOF LEVEL)

DRAWN BY: NG	DATE: 15 FEBRUARY 2021
CHECKED BY: NM	SCALE: AS NOTED

PROJECT NO.: 21-23
DRAWING NO.: A-1.1

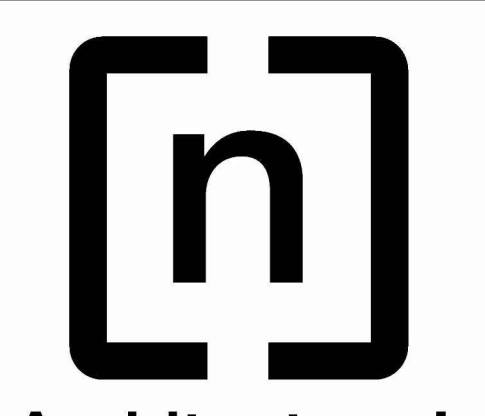
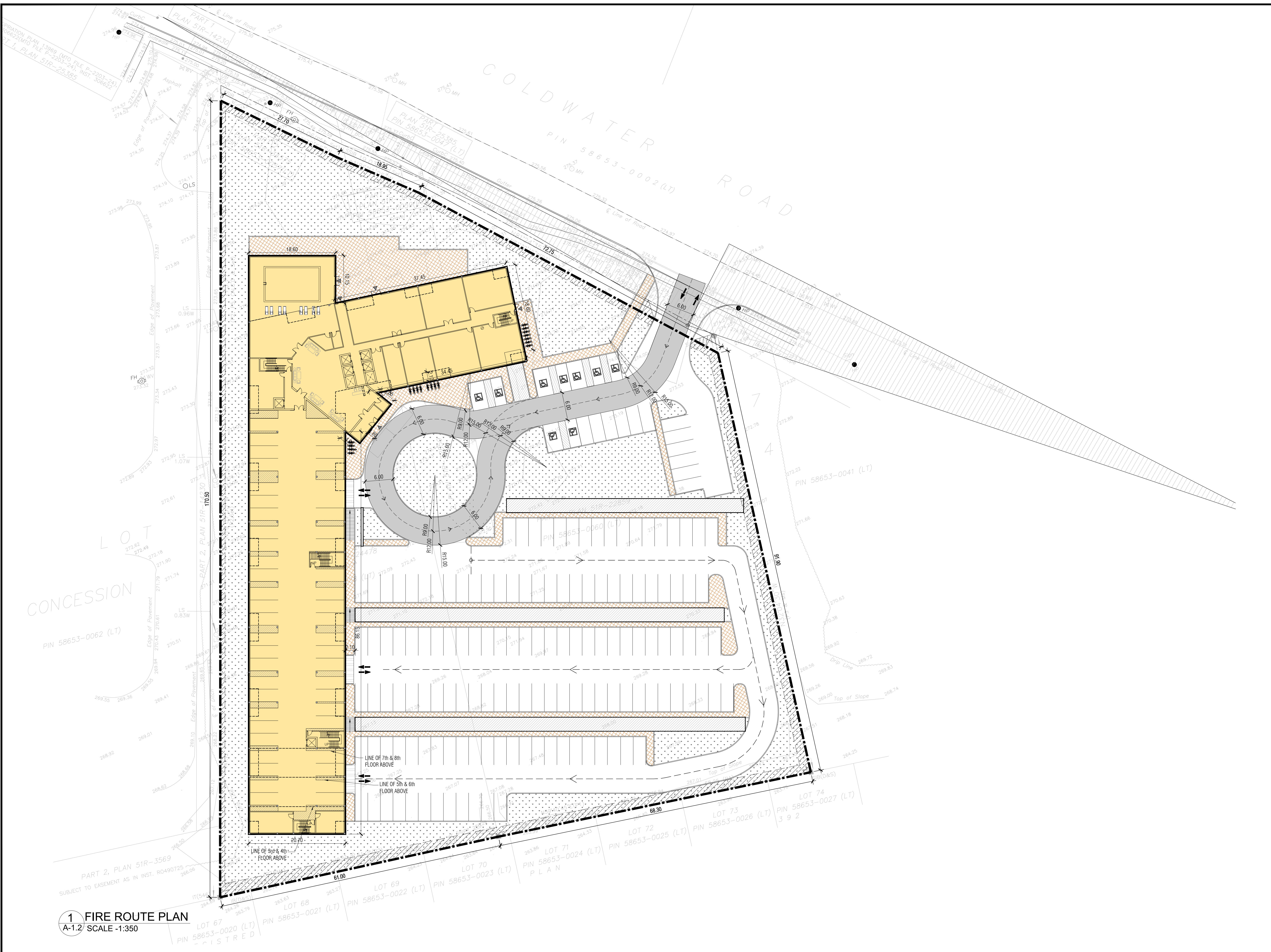

n Architecture Inc
 PRINCIPAL: NITIN MALHOTRA, ARCHITECT.
 9120 Leslie Street, Suite-208
 Richmond Hill, Ontario. L4B 3J9
 T : 4 1 6 . 2 5 6 . 9 7 4 1
 E: info@narchitecture.com

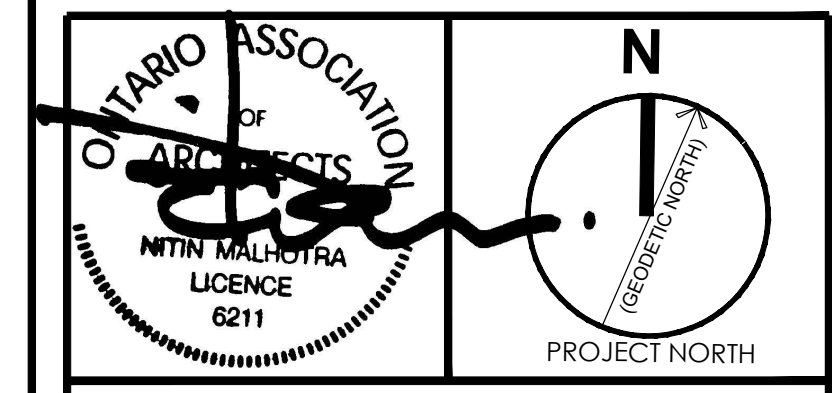

3rd OCTOBER 2022
 ISSUED FOR SPA 1

No.	Date	Version	Dwn.
1.	2022-10-03	ISSUED FOR SPA 1	NG.

This drawing is copyright property of 'n Architecture Inc'. Not to be reproduced, drawings, details and specifications and report any discrepancies to the architect before proceeding with work.

PROJECT:
**CONDOMINIUM
 233,249,261
 COLDWATER ROAD,
 WEST, ORILIA**

DRAWING TITLE:
**FIRE ROUTE
 PLAN**

DRAWN BY: NG	DATE: 15 FEBRUARY 2021
CHECKED BY: NM	SCALE: AS NOTED
PROJECT NO.:	DRAWING NO.:
21-23	A-1.2



n Architecture Inc

PRINCIPAL: NITIN MALHOTRA, ARCHITECT.
 9120 Leslie Street, Suite-208
 Richmond Hill, Ontario. L4B 3J9
 T : 4 1 6 . 2 5 6 . 9 7 4 1
 E: info@narchitecture.com
 .com

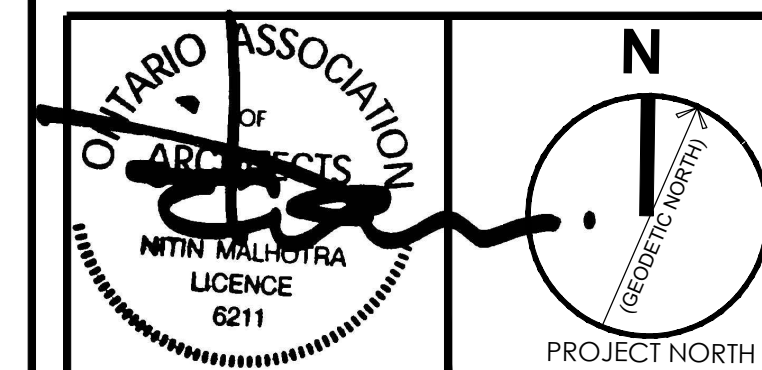

3RD OCTOBER 2022
 ISSUED FOR SPA 1

No.	Date	Version	Dwn.
1.	2022.10.03	ISSUED FOR SPA 1	NG

This drawing is copyright property of 'n Architecture Inc'. Not to be reproduced. Contractor must verify all job dimensions, drawings, details and specifications and report any discrepancies to the architect before proceeding with work.

PROJECT:
**CONDOMINIUM
 233,249,261
 COLDWATER ROAD,
 WEST, ORILIA**

DRAWING TITLE:
**BUILDING-A
 GROUND FLOOR PLAN**

DRAWN BY: MK DATE: 15 FEBRUARY 2021
 CHECKED BY: NM SCALE: AS NOTED

PROJECT NO.: DRAWING NO.:
21-23 A-2.0

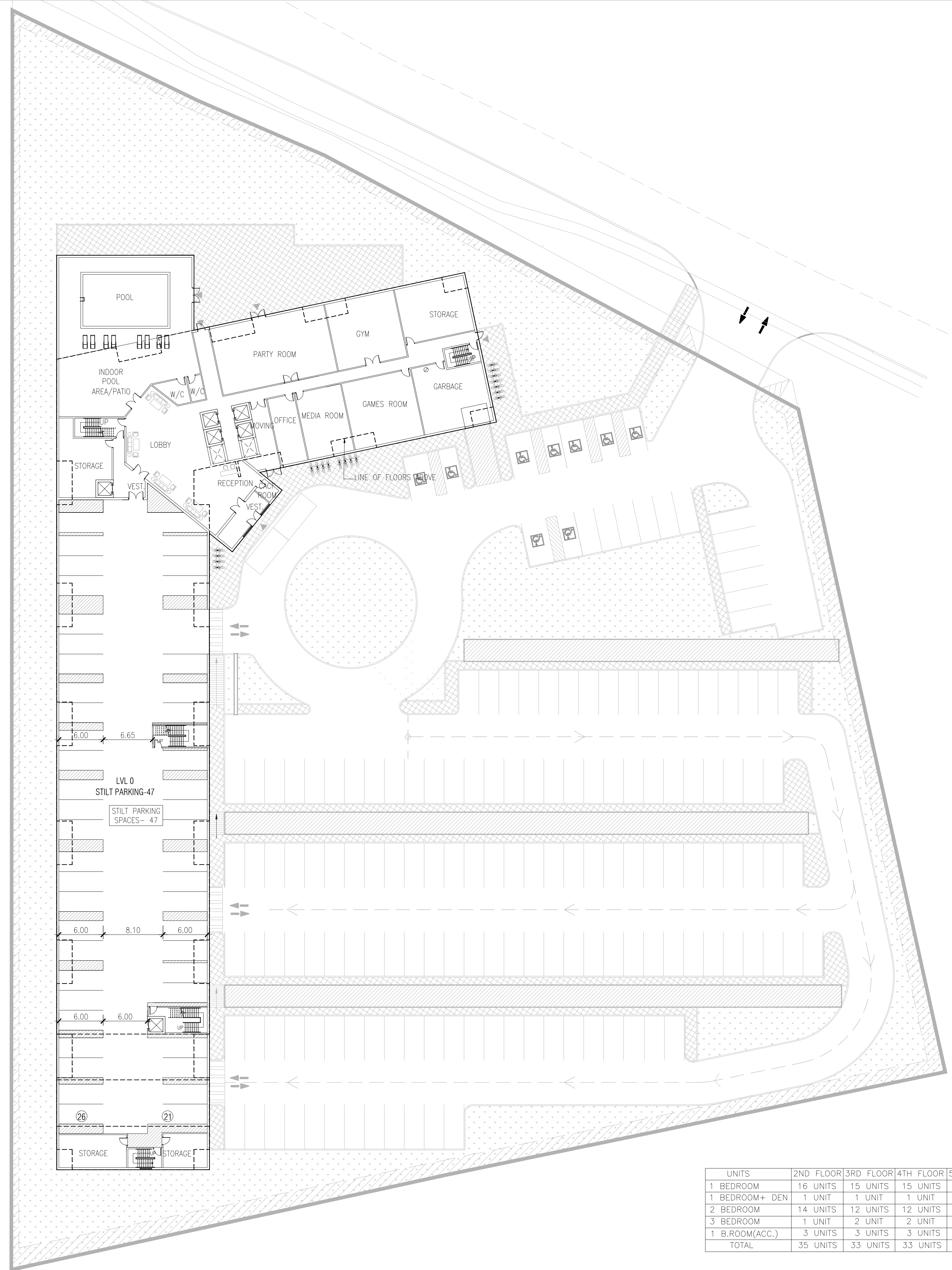

UNITS	2ND FLOOR	3RD FLOOR	4TH FLOOR	5TH FLOOR	6TH FLOOR	7TH FLOOR	8TH FLOOR	TOTAL
1 BEDROOM	16 UNITS	15 UNITS	15 UNITS	15 UNITS	15 UNITS	13 UNITS	13 UNITS	102 UNITS
1 BEDROOM+ DEN	1 UNIT	1 UNIT	1 UNIT	1 UNIT	1 UNIT	1 UNIT	1 UNIT	07 UNITS
2 BEDROOM	14 UNITS	12 UNITS	12 UNITS	12 UNITS	12 UNITS	12 UNITS	12 UNITS	86 UNITS
3 BEDROOM	1 UNIT	2 UNIT	2 UNIT	1 UNIT	1 UNIT	1 UNIT	1 UNIT	09 UNITS
1 B.ROOM(ACC.)	3 UNITS	3 UNITS	3 UNITS	3 UNITS	3 UNITS	3 UNITS	3 UNITS	21 UNITS
TOTAL	35 UNITS	33 UNITS	33 UNITS	32 UNITS	32 UNITS	30 UNITS	30 UNITS	225 UNITS

1 GROUND FLOOR PLAN
 A-2.0 SCALE -1:300

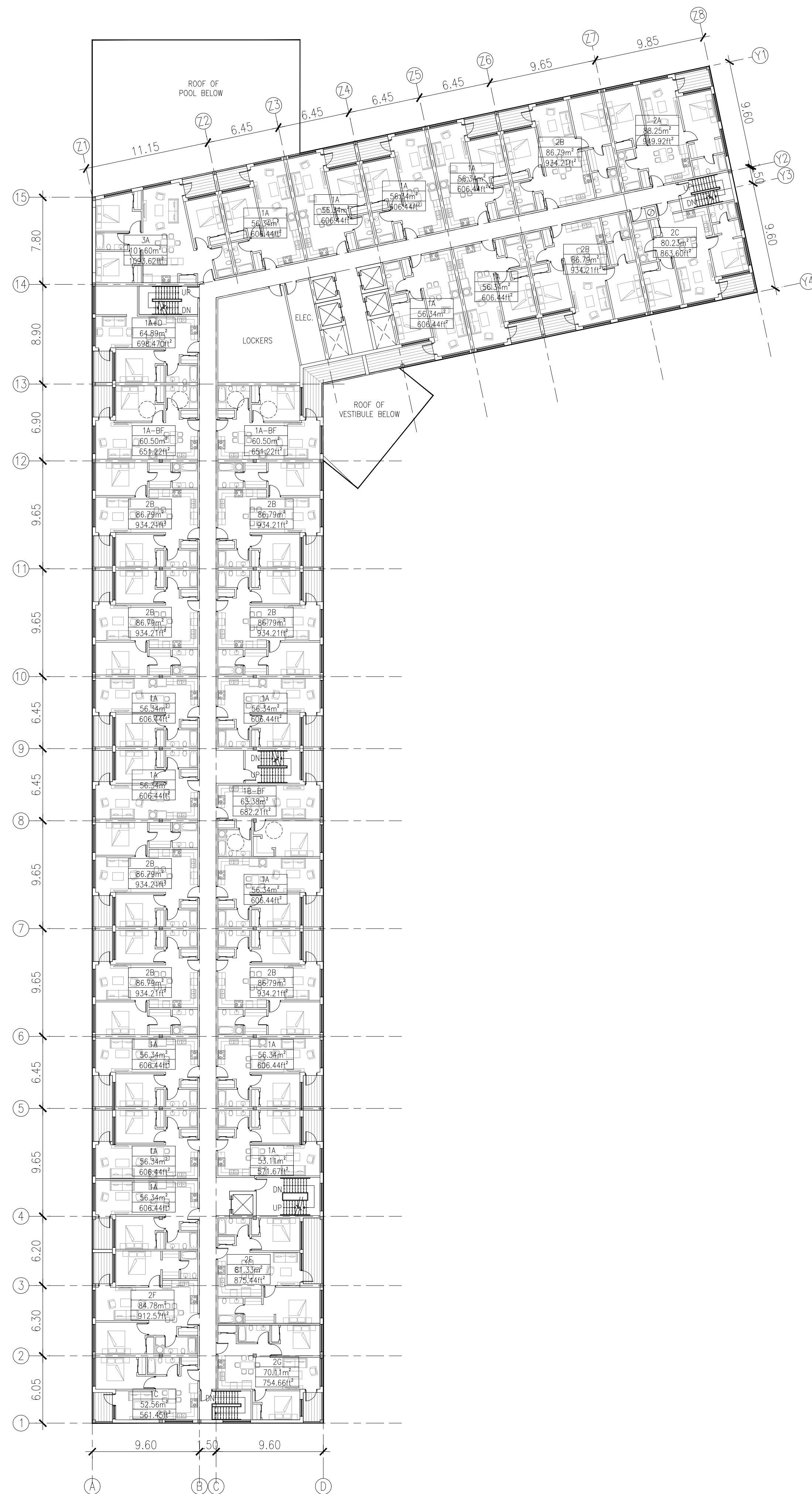

1 SECOND FLOOR PLAN
A-2.1 SCALE -1:250

UNITS	2ND FLOOR	3RD FLOOR	4TH FLOOR	5TH FLOOR	6TH FLOOR	7TH FLOOR	8TH FLOOR	TOTAL
1 BEDROOM	16 UNITS	15 UNITS	15 UNITS	15 UNITS	15 UNITS	13 UNITS	13 UNITS	102 UNITS
1 BEDROOM+ DEN	1 UNIT	1 UNIT	1 UNIT	1 UNIT	1 UNIT	1 UNIT	1 UNIT	07 UNITS
2 BEDROOM	14 UNITS	12 UNITS	12 UNITS	12 UNITS	12 UNITS	12 UNITS	12 UNITS	86 UNITS
3 BEDROOM	1 UNIT	2 UNIT	2 UNIT	1 UNIT	1 UNIT	1 UNIT	1 UNIT	09 UNITS
1 B.ROOM(ACC.)	3 UNITS	3 UNITS	3 UNITS	3 UNITS	3 UNITS	3 UNITS	3 UNITS	21 UNITS
TOTAL	35 UNITS	33 UNITS	33 UNITS	32 UNITS	32 UNITS	30 UNITS	30 UNITS	225 UNITS

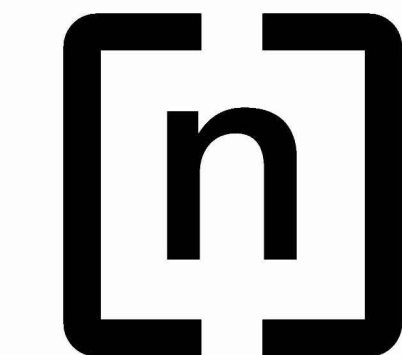

n Architecture Inc

PRINCIPAL: NITIN MALHOTRA, ARCHITECT.
9120 Leslie Street, Suite-208
Richmond Hill, Ontario. L4B 3J9
T : 4 1 6 . 2 5 6 . 9 7 4 1
E: info@narchitecture.com
.com

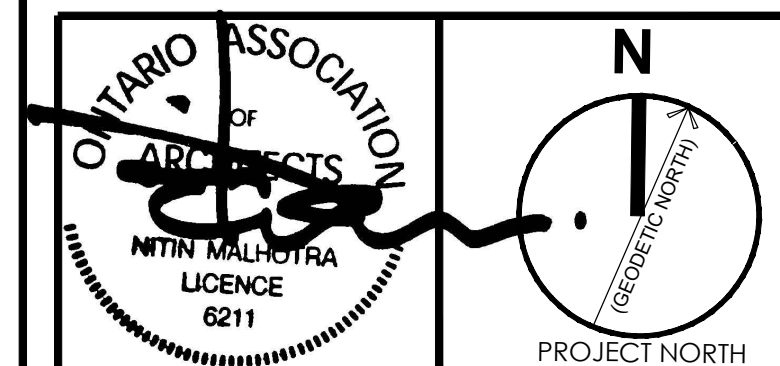

3RD OCTOBER 2022
ISSUED FOR SPA 1

No.	Date	Version	Dwn.
1.	2022.10.03	ISSUED FOR SPA 1	NG

This drawing is copyright property of 'n Architecture Inc'. Not to be reproduced. Contractor must verify all job dimensions, drawings, details and specifications and report any discrepancies to the architect before proceeding with work.

PROJECT:
**CONDOMINIUM
233,249,261
COLDWATER ROAD,
WEST, ORILIA**

DRAWING TITLE:
**BUILDING-A
SECOND FLOOR PLAN**

DRAWN BY: MK DATE: 15 FEBRUARY 2021

CHECKED BY: NM SCALE: AS NOTED

PROJECT NO.: DRAWING NO.:

21-23 A-2.1

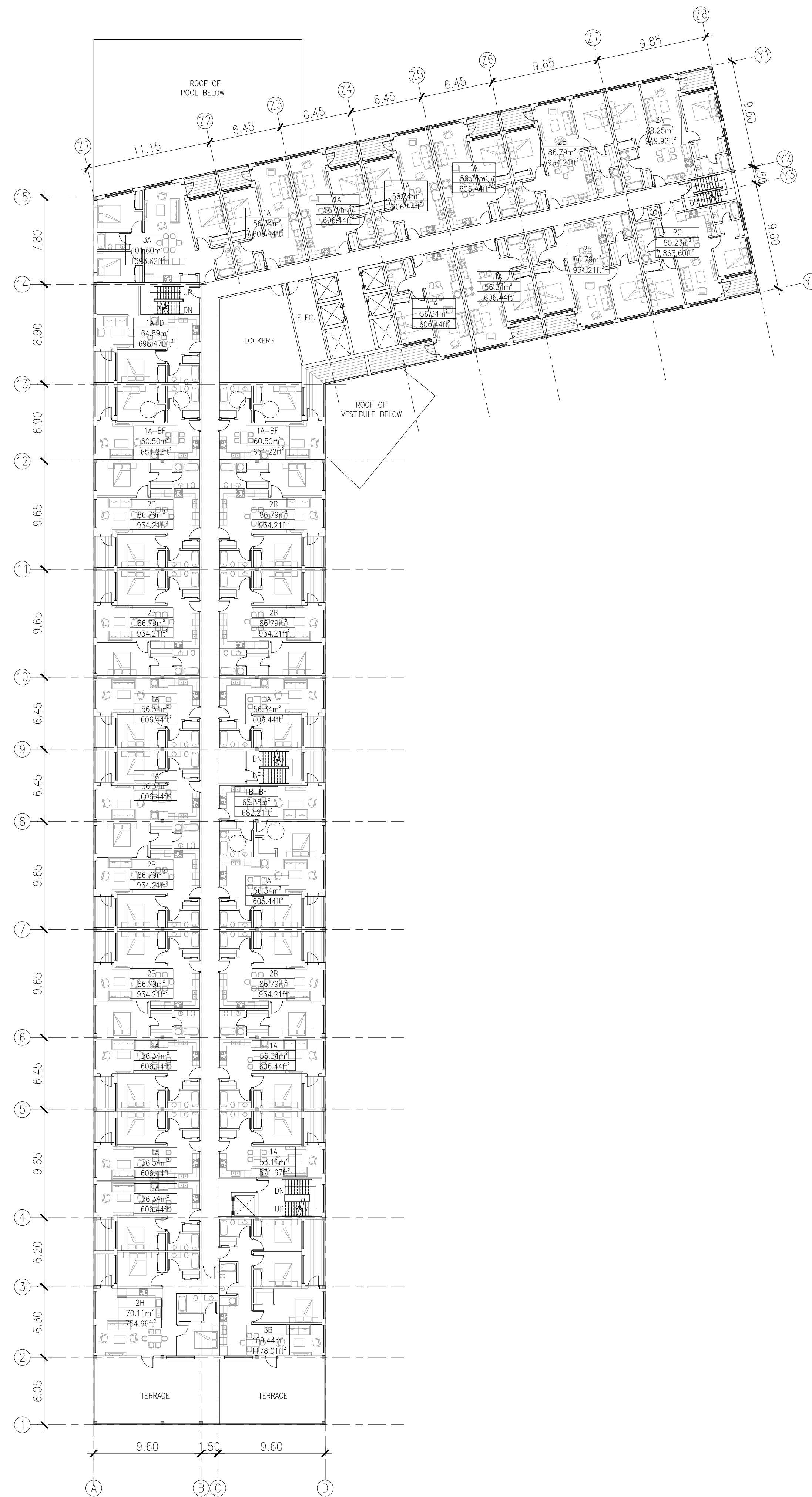

1 THIRD & FOURTH FLOOR PLAN
A-2.2 SCALE -1:250

UNITS	2ND FLOOR	3RD FLOOR	4TH FLOOR	5TH FLOOR	6TH FLOOR	7TH FLOOR	8TH FLOOR	TOTAL
1 BEDROOM	16 UNITS	15 UNITS	15 UNITS	15 UNITS	15 UNITS	13 UNITS	13 UNITS	102 UNITS
1 BEDROOM+ DEN	1 UNIT	1 UNIT	1 UNIT	1 UNIT	1 UNIT	1 UNIT	1 UNIT	07 UNITS
2 BEDROOM	14 UNITS	12 UNITS	12 UNITS	12 UNITS	12 UNITS	12 UNITS	12 UNITS	86 UNITS
3 BEDROOM	1 UNIT	2 UNIT	2 UNIT	1 UNIT	1 UNIT	1 UNIT	1 UNIT	09 UNITS
1 B.ROOM(ACC.)	3 UNITS	3 UNITS	3 UNITS	3 UNITS	3 UNITS	3 UNITS	3 UNITS	21 UNITS
TOTAL	35 UNITS	33 UNITS	33 UNITS	32 UNITS	32 UNITS	30 UNITS	30 UNITS	225 UNITS

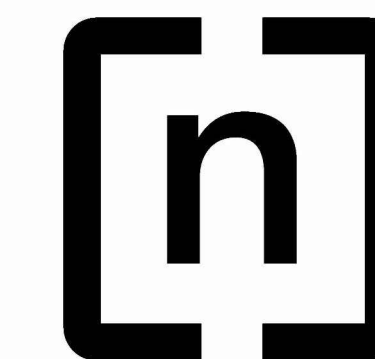

n Architecture Inc

PRINCIPAL: NITIN MALHOTRA, ARCHITECT.
9120 Leslie Street, Suite-208
Richmond Hill, Ontario. L4B 3J9
T : 4 1 6 . 2 5 6 . 9 7 4 1
E: info@narchitecture.com
.com

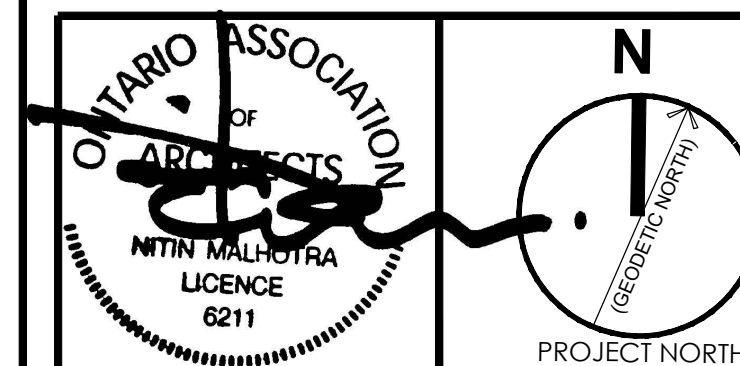

3RD OCTOBER 2022
ISSUED FOR SPA 1

No.	Date	Version	Dwn.
1.	2022.10.03	ISSUED FOR SPA 1	NG

This drawing is copyright property of 'n Architecture Inc'. Not to be reproduced. Contractor must verify all job dimensions, drawings, details and specifications and report any discrepancies to the architect before proceeding with work.

PROJECT:
**CONDOMINIUM
233,249,261
COLDWATER ROAD,
WEST, ORILIA**

DRAWING TITLE:
**BUILDING-A
THIRD & FOURTH
FLOOR PLAN**

DRAWN BY: MK DATE: 15 FEBRUARY 2021

CHECKED BY: NM SCALE: AS NOTED

PROJECT NO.: DRAWING NO.:

21-23 A-2.2

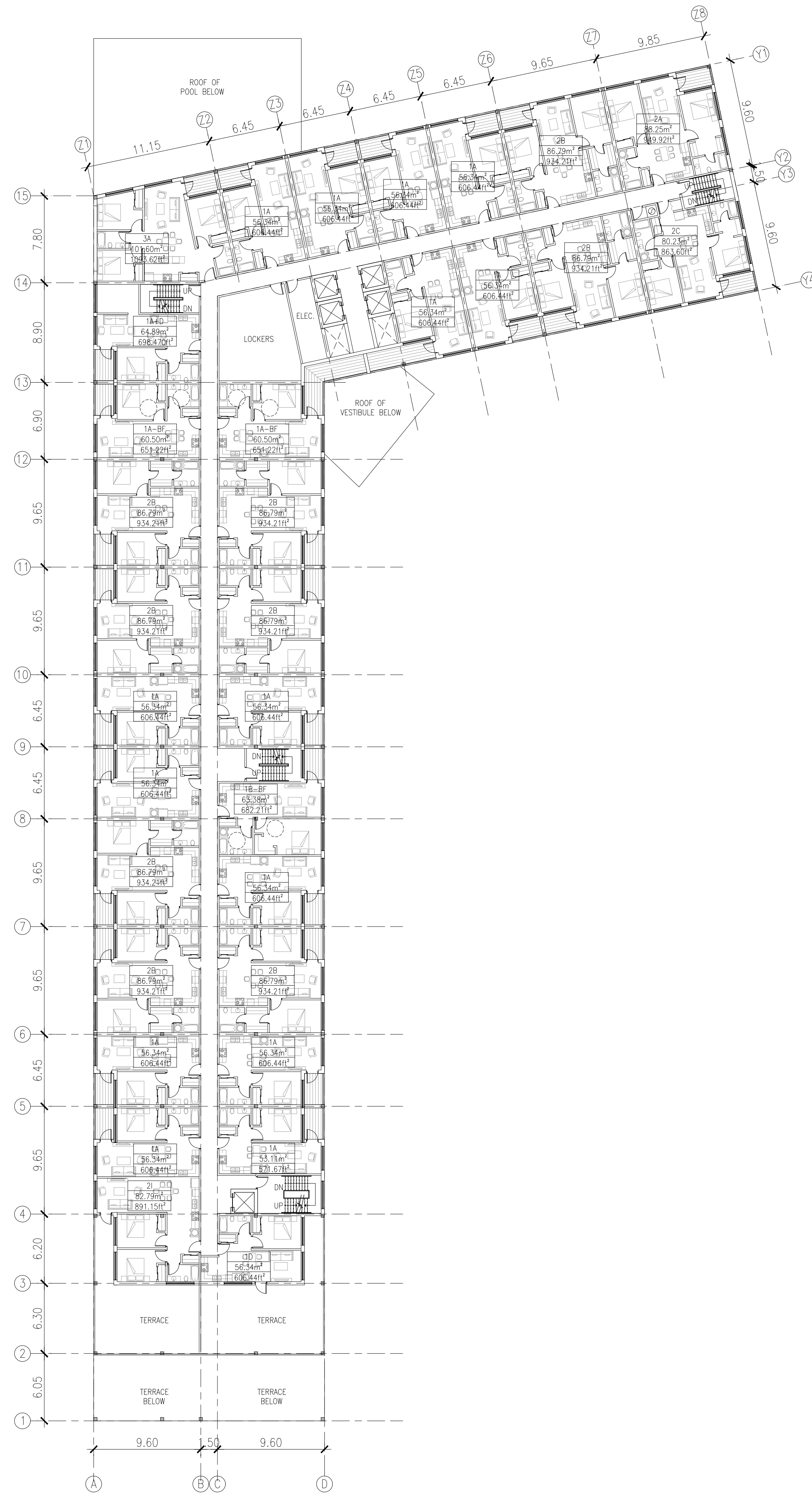

1 FIFTH & SIXTH FLOOR PLAN
A-2.3 SCALE -1:250

UNITS	2ND FLOOR	3RD FLOOR	4TH FLOOR	5TH FLOOR	6TH FLOOR	7TH FLOOR	8TH FLOOR	TOTAL
1 BEDROOM	16 UNITS	15 UNITS	15 UNITS	15 UNITS	15 UNITS	13 UNITS	13 UNITS	102 UNITS
1 BEDROOM+ DEN	1 UNIT	1 UNIT	1 UNIT	1 UNIT	1 UNIT	1 UNIT	1 UNIT	07 UNITS
2 BEDROOM	14 UNITS	12 UNITS	12 UNITS	12 UNITS	12 UNITS	12 UNITS	12 UNITS	86 UNITS
3 BEDROOM	1 UNIT	2 UNIT	2 UNIT	1 UNIT	1 UNIT	1 UNIT	1 UNIT	09 UNITS
1 B.ROOM(ACC.)	3 UNITS	3 UNITS	3 UNITS	3 UNITS	3 UNITS	3 UNITS	3 UNITS	21 UNITS
TOTAL	35 UNITS	33 UNITS	33 UNITS	32 UNITS	32 UNITS	30 UNITS	30 UNITS	225 UNITS

n Architecture Inc
 PRINCIPAL: NITIN MALHOTRA, ARCHITECT.
 9120 Leslie Street, Suite-208
 Richmond Hill, Ontario. L4B 3J9
 T : 4 1 6 . 2 5 6 . 9 7 4 1
 E : info@narchitecture.com

3RD OCTOBER 2022
ISSUED FOR SPA 1

No.	Date	Version	Dwn.
1.	2022.10.03	ISSUED FOR SPA 1	NG

This drawing is copyright property of 'n Architecture Inc'. Not to be reproduced. Contractor must verify all job dimensions, drawings, details and specifications and report any discrepancies to the architect before proceeding with work.

PROJECT:
**CONDOMINIUM
 233,249,261
 COLDWATER ROAD,
 WEST, ORILIA**

DRAWING TITLE:
**BUILDING-A
 FIFTH & SIXTH
 FLOOR PLAN**

DRAWN BY: MK DATE: 15 FEBRUARY 2021
 CHECKED BY: NM SCALE: AS NOTED

PROJECT NO.: DRAWING NO.:
21-23 A-2.3

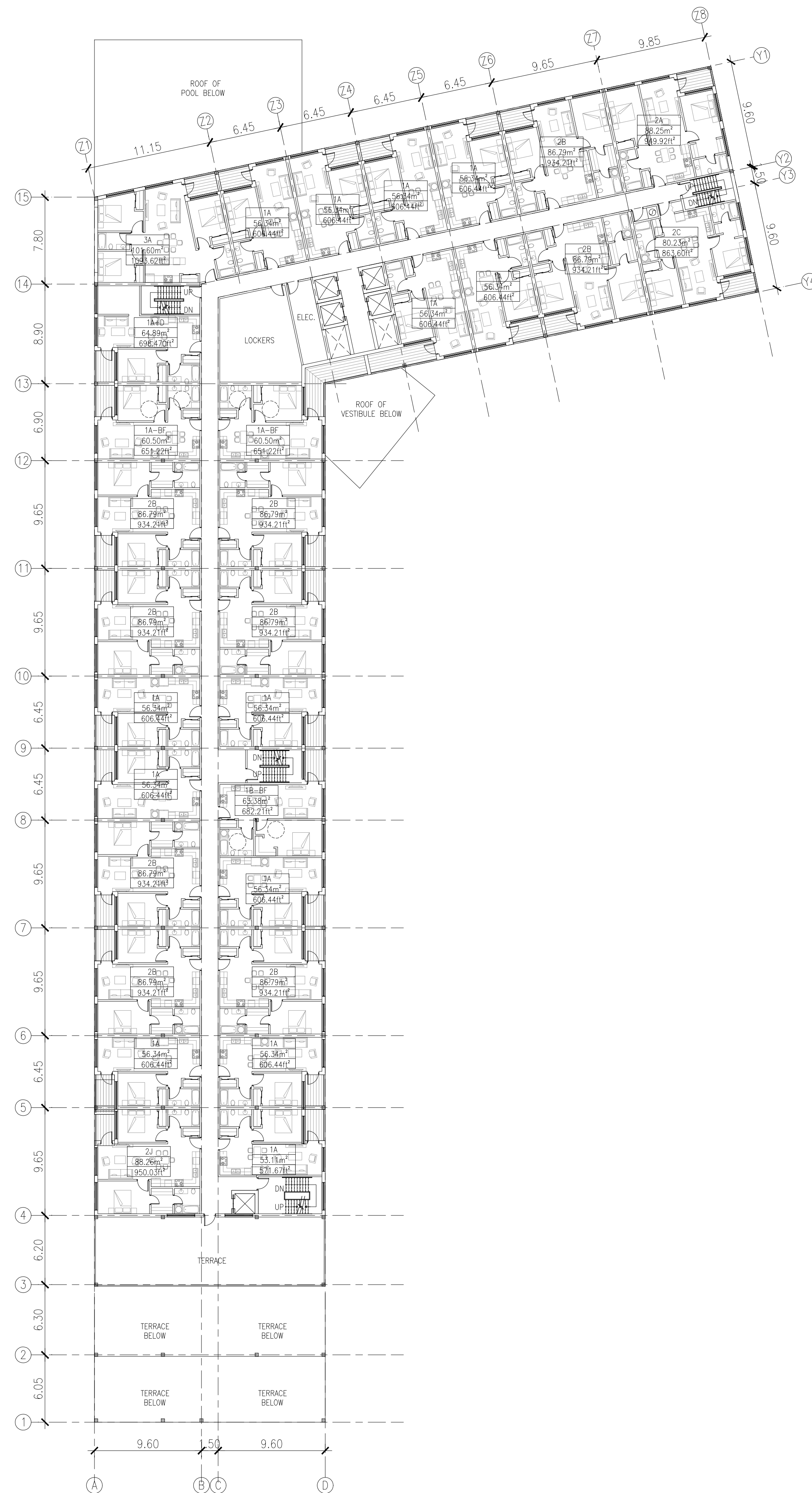

1 SEVENTH & EIGHTH FLOOR PLAN
A-2.4 SCALE -1:250

UNITS	2ND FLOOR	3RD FLOOR	4TH FLOOR	5TH FLOOR	6TH FLOOR	7TH FLOOR	8TH FLOOR	TOTAL
1 BEDROOM	16 UNITS	15 UNITS	15 UNITS	15 UNITS	15 UNITS	13 UNITS	13 UNITS	102 UNITS
1 BEDROOM+ DEN	1 UNIT	1 UNIT	1 UNIT	1 UNIT	1 UNIT	1 UNIT	1 UNIT	07 UNITS
2 BEDROOM	14 UNITS	12 UNITS	12 UNITS	12 UNITS	12 UNITS	12 UNITS	12 UNITS	86 UNITS
3 BEDROOM	1 UNIT	2 UNIT	2 UNIT	1 UNIT	1 UNIT	1 UNIT	1 UNIT	09 UNITS
1 B.ROOM(ACC.)	3 UNITS	3 UNITS	3 UNITS	3 UNITS	3 UNITS	3 UNITS	3 UNITS	21 UNITS
TOTAL	35 UNITS	33 UNITS	33 UNITS	32 UNITS	32 UNITS	30 UNITS	30 UNITS	225 UNITS

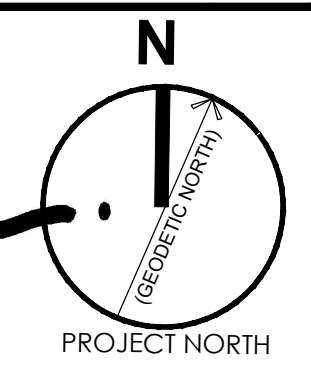

n Architecture Inc
 PRINCIPAL: NITIN MALHOTRA, ARCHITECT.
 9120 Leslie Street, Suite-208
 Richmond Hill, Ontario. L4B 3J9
 T : 4 1 6 . 2 5 6 . 9 7 4 1
 E: info@narchitecture.com
 .com

ONTARIO ASSOCIATION OF ARCHITECTS
 NITIN MALHOTRA
 LICENCE 6211
 PROJECT NORTH

3RD OCTOBER 2022
 ISSUED FOR SPA 1

1.	2022.10.03	ISSUED FOR SPA 1	NG
No.	Date	Version	Dwn.

This drawing is copyright property of 'n Architecture Inc'. Not to be reproduced. Contractor must verify all job dimensions, drawings, details and specifications and report any discrepancies to the architect before proceeding with work.

PROJECT:
**CONDOMINIUM
 233,249,261
 COLDWATER ROAD,
 WEST, ORILIA**

DRAWING TITLE:
**BUILDING-A
 SEVENTH & EIGHTH
 FLOOR PLAN**

DRAWN BY: MK DATE: 15 FEBRUARY 2021

CHECKED BY: NM SCALE: AS NOTED

PROJECT NO.: DRAWING NO.:

21-23 A-2.4

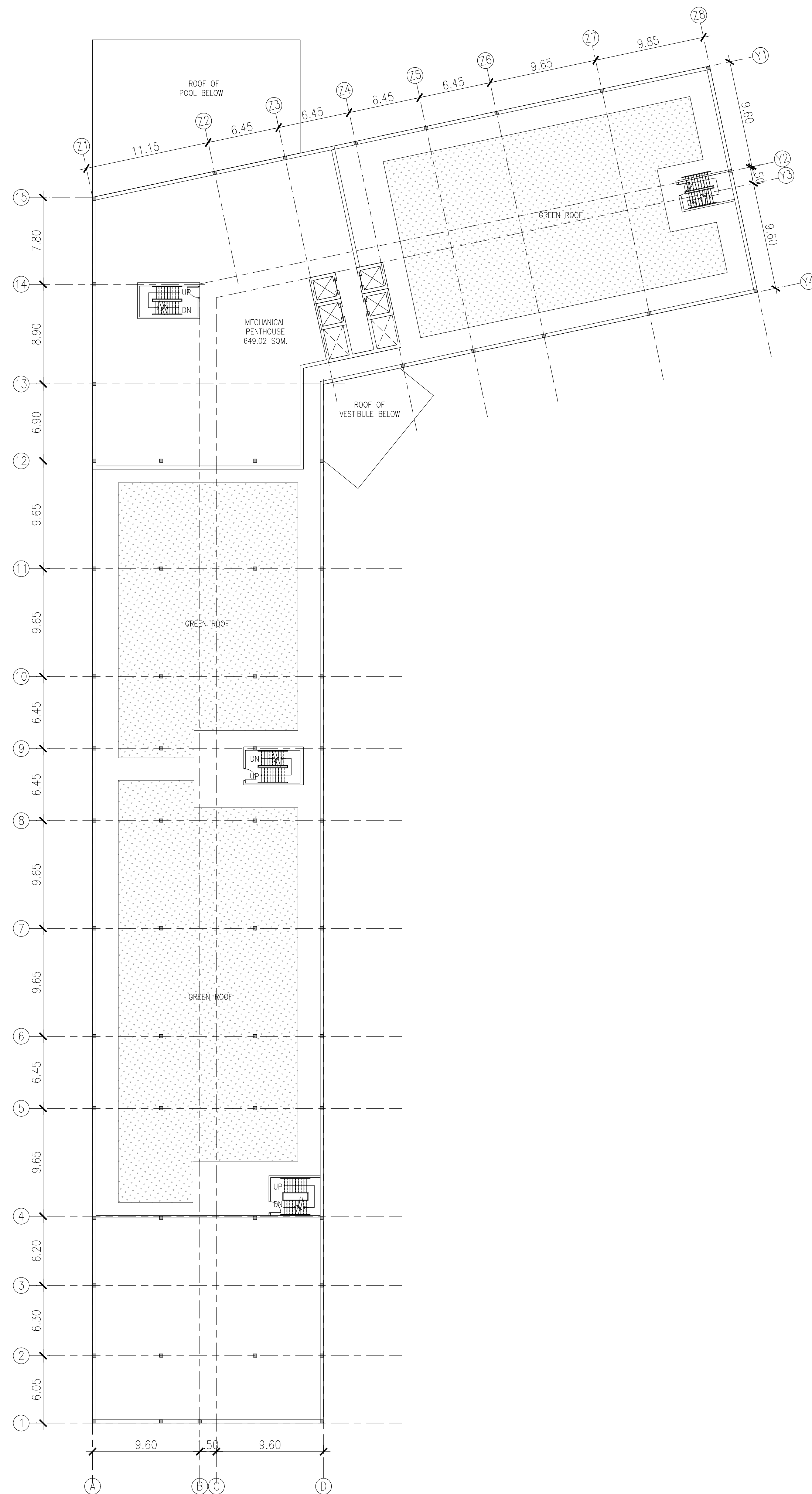

1 MECHANICAL PENTHOUSE PLAN
A-2.5 SCALE -1:250

UNITS	2ND FLOOR	3RD FLOOR	4TH FLOOR	5TH FLOOR	6TH FLOOR	7TH FLOOR	8TH FLOOR	TOTAL
1 BEDROOM	16 UNITS	15 UNITS	15 UNITS	15 UNITS	15 UNITS	13 UNITS	13 UNITS	102 UNITS
1 BEDROOM+ DEN	1 UNIT	1 UNIT	1 UNIT	1 UNIT	1 UNIT	1 UNIT	1 UNIT	07 UNITS
2 BEDROOM	14 UNITS	12 UNITS	12 UNITS	12 UNITS	12 UNITS	12 UNITS	12 UNITS	86 UNITS
3 BEDROOM	1 UNIT	2 UNIT	2 UNIT	1 UNIT	1 UNIT	1 UNIT	1 UNIT	09 UNITS
1 B.ROOM(ACC.)	3 UNITS	3 UNITS	3 UNITS	3 UNITS	3 UNITS	3 UNITS	3 UNITS	21 UNITS
TOTAL	35 UNITS	33 UNITS	33 UNITS	32 UNITS	32 UNITS	30 UNITS	30 UNITS	225 UNITS

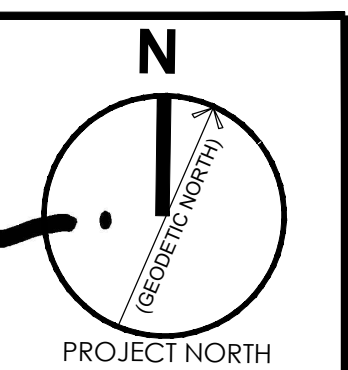

n Architecture Inc
 PRINCIPAL: NITIN MALHOTRA, ARCHITECT.
 9120 Leslie Street, Suite-208
 Richmond Hill, Ontario. L4B 3J9
 T : 4 1 6 . 2 5 6 . 9 7 4 1
 E: info@narchitecture.com
 .com

ONTARIO ASSOCIATION OF ARCHITECTS
 NITIN MALHOTRA
 LICENCE 6211

PROJECT NORTH

3RD OCTOBER 2022
 ISSUED FOR SPA 1

1.	2022.10.03	ISSUED FOR SPA 1	NG
No.	Date	Version	Dwn.

This drawing is copyright property of 'n Architecture Inc'. Not to be reproduced. Contractor must verify all job dimensions, drawings, details and specifications and report any discrepancies to the architect before proceeding with work.

PROJECT:
**CONDOMINIUM
 233,249,261
 COLDWATER ROAD,
 WEST, ORILIA**

DRAWING TITLE:
**BUILDING-A
 MECHANICAL
 PENTHOUSE PLAN**

DRAWN BY: MK DATE: 15 FEBRUARY 2021
 CHECKED BY: NM SCALE: AS NOTED

PROJECT NO.: DRAWING NO.:
21-23 A-2.5



n Architecture Inc

PRINCIPAL: NITIN MALHOTRA, ARCHITECT.
9120 Leslie Street, Suite-208
Richmond Hill, Ontario. L4B 3J9
T : 4 1 6 . 2 5 6 . 9 7 4 1
E: info@narchitecture.com
.com

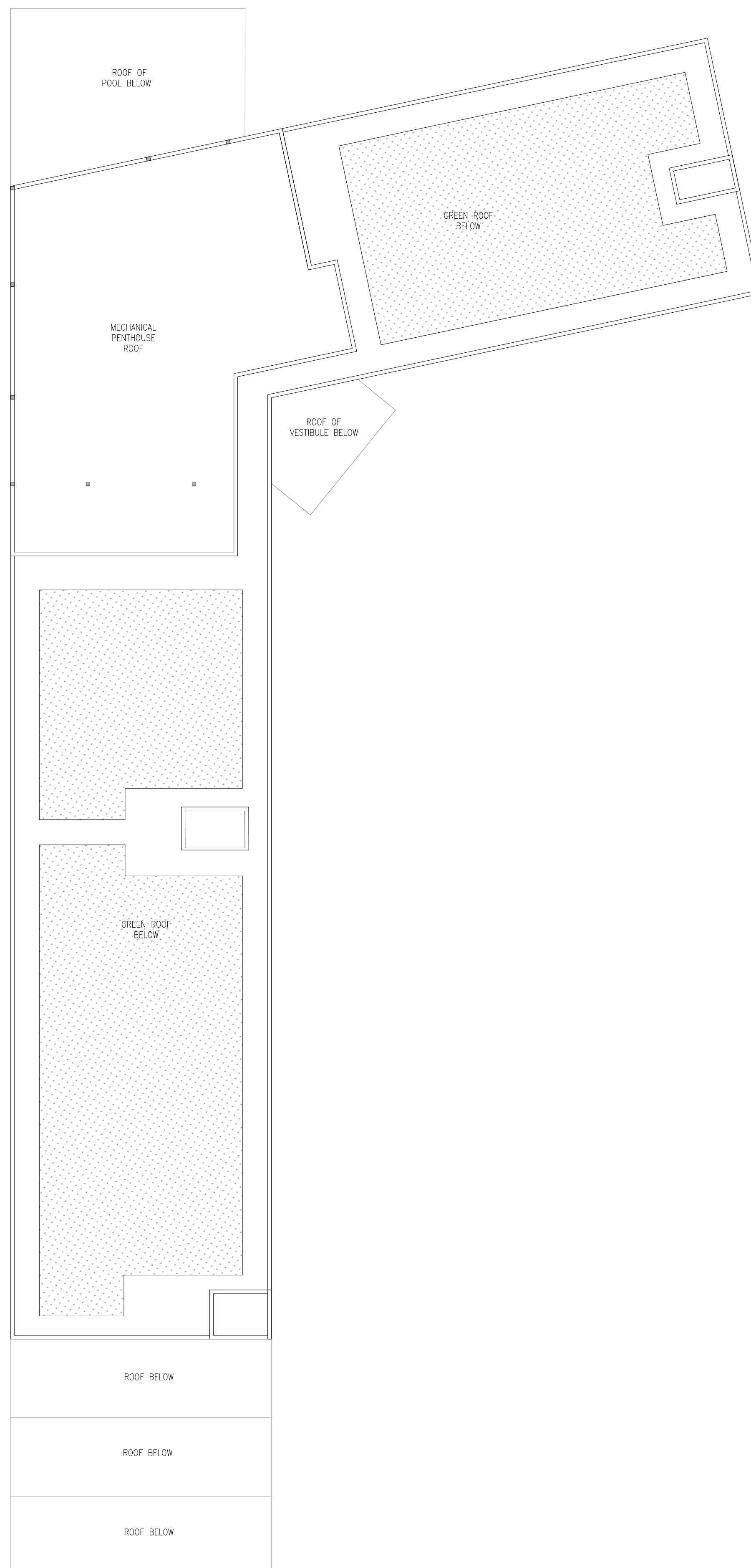
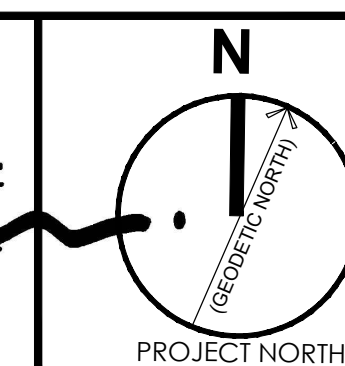

3RD OCTOBER 2022
ISSUED FOR SPA 1

No.	Date	Version	Dwn.
1.	2022.10.03	ISSUED FOR SPA 1	NG

This drawing is copyright property of 'n Architecture Inc'. Not to be reproduced. Contractor must verify all job dimensions, drawings, details and specifications and report any discrepancies to the architect before proceeding with work.

PROJECT:
**CONDOMINIUM
233,249,261
COLDWATER ROAD,
WEST, ORILIA**

DRAWING TITLE:
**BUILDING-A
ROOF PLAN**

DRAWN BY: MK	DATE: 15 FEBRUARY 2021
CHECKED BY: NM	SCALE: AS NOTED
PROJECT NO.:	DRAWING NO.:

21-23 A-2.6

1 ROOF PLAN
A-2.6 SCALE -1:250

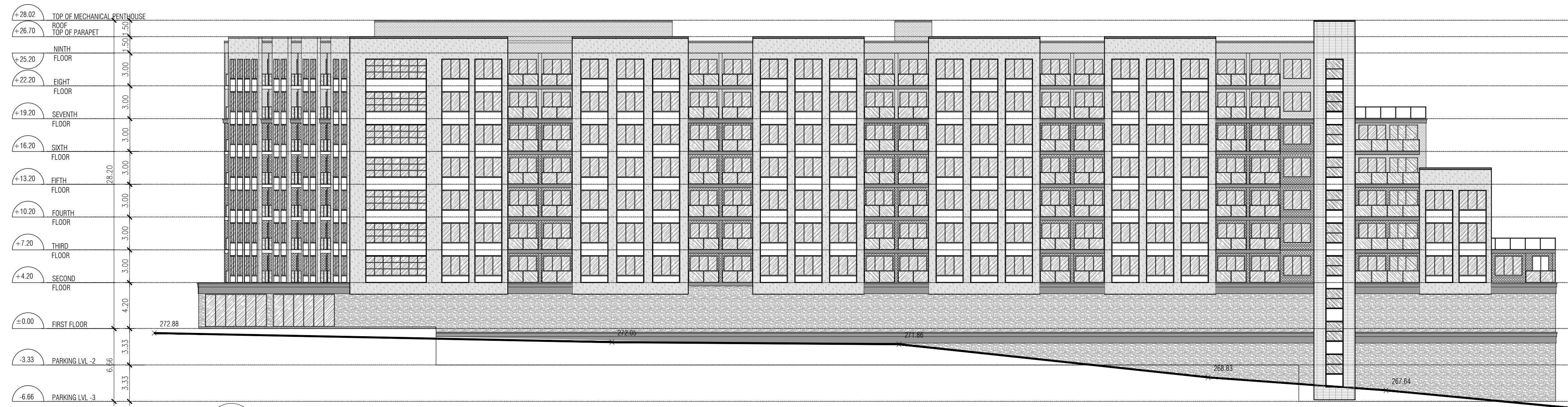

1 WEST ELEVATION
A-3.0 SCALE -1:250



2 NORTH ELEVATION
A-3.0 SCALE -1:250

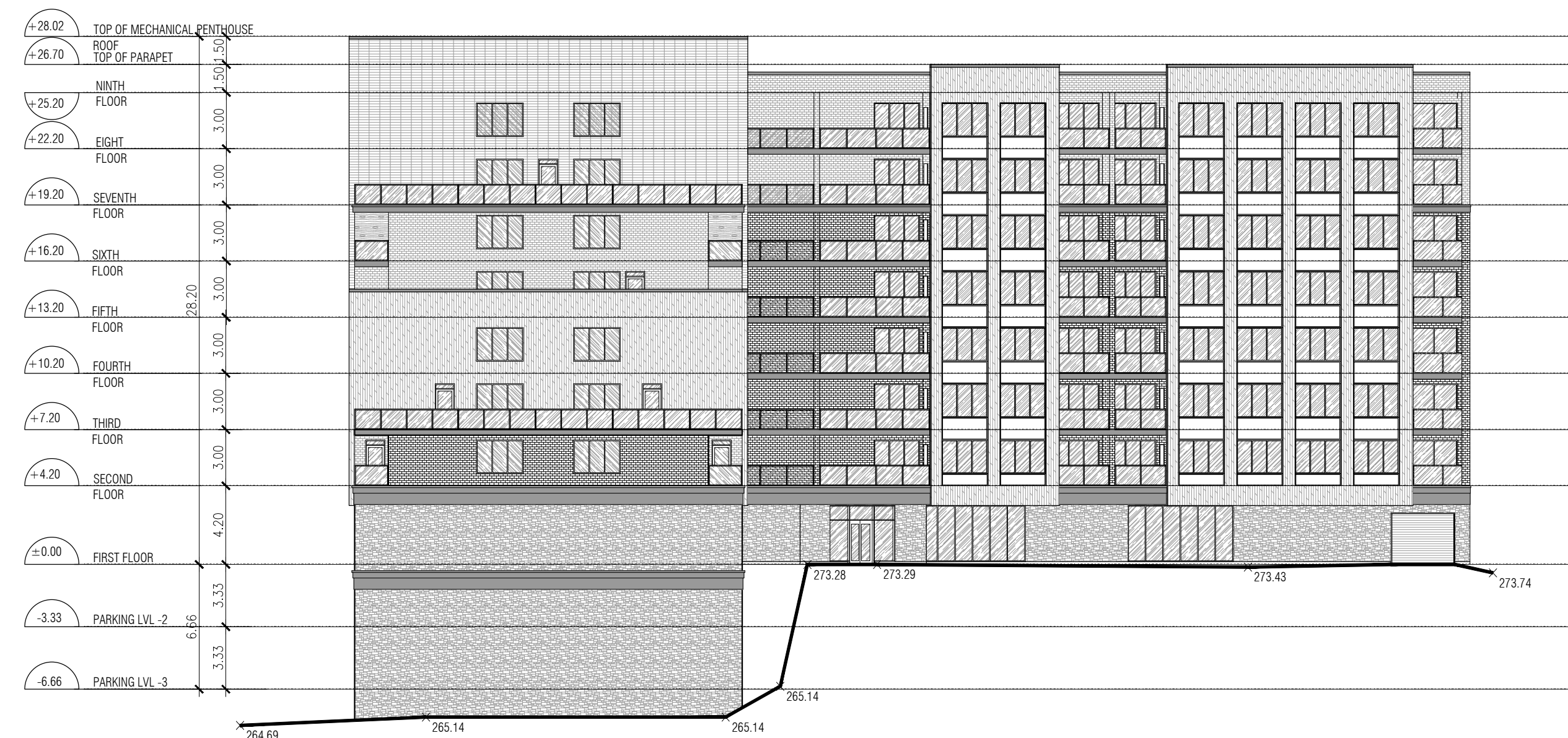

3 SOUTH ELEVATION
A-3.0 SCALE -1:250



4 EAST ELEVATION
A-3.0 SCALE -1:250

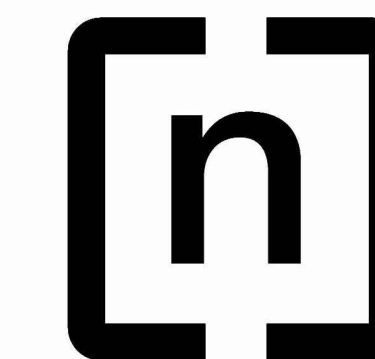

n Architecture Inc

PRINCIPAL: NITIN MALHOTRA, ARCHITECT.
9120 Leslie Street, Suite-208
Richmond Hill, Ontario, L4B 3J9
T : 4 1 6 . 2 5 6 . 9 7 4 1
E : info@narchitecture.com



3RD OCTOBER 2022
ISSUED FOR SPA 1

No.	Date	Version	Dwn.
1.	2022.10.03	ISSUED FOR SPA 1	NG

This drawing is copyright property of 'n Architecture Inc'. Not to be reproduced. Contractor must verify all job dimensions, drawings, details and specifications and report any discrepancies to the architect before proceeding with work.

PROJECT:
**CONDOMINIUM
233,249,261
COLDWATER ROAD,
WEST, ORILIA**

DRAWING TITLE:
**BUILDING
ELEVATIONS**

DRAWN BY: MK DATE: 15 FEBRUARY 2021

CHECKED BY: NM SCALE: AS NOTED

PROJECT NO.: DRAWING NO.:

21-23 A-3.0